

Mast guide bearing MG45MM-A-ENDURO - MG45MM-A-ENDURO

<https://www.123bearing.com/bearing-housing/deep-groove-bearing/mast-guide/mg45mm-a-enduro>

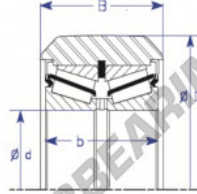

Part Number	Style	Inner Diameter, d	Outer Diameter, D	Inner Ring Width, b	Outer Ring Width, B	Radius, R	Dynamic Capacity	Static Capacity
MG 45mm-A	® → Double row TBR insert	45.240 mm	111.40 mm	44.283 mm	50.800 mm	chamfer	119,212 kN	155,687 kN

PRODUCT FEATURES

Brand	ENDURO
N° Ean13	3616060581334
Inside diameter	45.24 mm
Outside diameter	111.4 mm
Thickness	50.8 mm
Dynamic load	119.212 kN
Static load	155.687 kN
Packaging	1

contact@123bearing.com

(646) 712 9672

CRT4 de Lesquin 60 Rue Du Haut De Sainghin 59273 Fretin FRANCE