

# SA Rod end BEM30-60-502-DURBAL - BEM30-60-502-DURBAL

<https://www.123bearing.com/bearing-housing/rod-end/sa/bem30-60-502-durbal>

## BEM30-60-502



male thread;  
maintenance free,  
adapter sizes  
according to  
DIN ISO 12240-4,  
series K

**DURBAL® heavy-duty rod ends  
with integral spherical  
plain bearing in stainless steel**

rod end housing:  
stainless steel 1.4301, rolled thread,  
surface with pickling treatment

joint ball:  
stainless steel, hardened and ground,  
surface superfinished

race:  
nylon / teflon / glass fibre compound

tolerances:  
see page 10

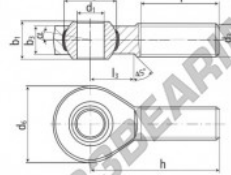

order number (right-hand / left-hand thread)	measurements [mm]							
type	d <sub>1</sub>	d <sub>2</sub>	d <sub>3</sub>	d <sub>4</sub>	h <sub>1</sub>	h <sub>2</sub>		
<b>BEM 30 -60</b>	<b>-502</b>	30	M 30 x 2	70	50,75	37	25,0	
type	measurements [mm]			weight	basic load rating dyn stat.			
type	h	l	l <sub>1</sub>	α <sub>1</sub> <sup>1</sup> [°]	α <sub>2</sub> <sup>2</sup> [°]	C <sub>1</sub> [N]	C <sub>2</sub> [N]	
<b>BEM 30</b>	110	66	35	17,0	10,5	1,015	33800	97100

## PRODUCT FEATURES

Brand	DURBAL
N° Ean13	3663952509891
Inside diameter	30 mm
Outside diameter	70 mm
Thickness	37 mm
Type	SA
Weight	1015 g
Thread	Left-hand thread
Lubrication	without
Packaging	1

[contact@123bearing.com](mailto:contact@123bearing.com)

(646) 712 9672

CRT4 de Lesquin 60 Rue Du Haut De Sainghin 59273 Fretin FRANCE