

## SI Rod end BEF22-20-502-DURBAL - BEF22-20-502-DURBAL

<https://www.123bearing.com/bearing-housing/rod-end/si/bef22-20-502-durbal>

### BEF22-20-502



**rod end housing:**  
forged steel, tempered, surface galvanized, free of Cr-VI

**joint ball:**  
ball bearing steel, hardened and ground, surface superfinished and chromium plated

**race:**  
nylon / teflon / glass fibre compound

**tolerances:**  
see page 10

**DURBAL® heavy-duty rod ends with integral spherical plain bearing**

**female thread:**  
maintenance free, adapter sizes according to DIN ISO 12240-4, series K, thread according to ISO 8139

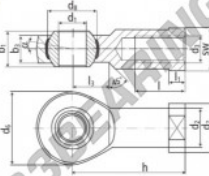

order number		measurements [mm]									
type	specification	d1	d2	d3	d4	d5	d6	d7	d8	h	l
BEF 22	-20 -502	22	30,0	M 22 x 1,5	54	38	38,05	28	20,0		
measurements [mm]		weight									
type	h	l	l1	l2	SW	α1°	α2°	weight [kg]	basic load rating		
BEF 22	84	37	12,0	26	32	15,5	10,0	0,520	38230	95600	

## PRODUCT FEATURES

Brand	DURBAL
N° Ean13	3663952508221
Inside diameter	22 mm
Inside diameter	0.866" inch
Outside diameter	54 mm
Outside diameter	2.126" inch
Thickness	28 mm
Thickness	1.102" inch
Type	SI
Weight	520 g
Thread	Left-hand thread
Lubrication	without
Packaging	1

[contact@123bearing.com](mailto:contact@123bearing.com)

(646) 712 9672

CRT4 de Lesquin 60 Rue Du Haut De Sainghin 59273 Fretin FRANCE