

SI Rod end BEF20-20-502-DURBAL - BEF20-20-502-DURBAL

<https://www.123bearing.com/bearing-housing/rod-end/si/bef20-20-502-durbal>

BEF20-20-502



rod end housing:
forged steel, tempered, surface galvanized, free of Cr-VI

joint ball:
ball bearing steel, hardened and ground, surface superfinished and chromium plated

race:
nylon / teflon / glass fibre compound

tolerances:
see page 10

DURBAL® heavy-duty rod ends with integral spherical plain bearing

female thread:
maintenance free, adapter sizes according to DIN ISO 12240-4, series K, thread according to ISO 8139

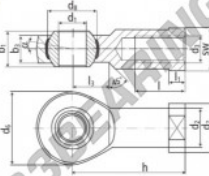

order number		measurements [mm]										weight	basic load rating	
type	right-hand thread / left-hand thread	d ₁	d ₂	d ₃	d ₄	d ₅	d ₆	d ₇	d ₈	b ₁	b ₂		dyn. C	stat. C ₀
BEF 20	-20	-502	20	27,5	M 20 x 1,5	50	34	34,87	25	18,0				
measurements [mm]		h	l	l ₁	l ₂	SW	α ₁ ¹ [°]	α ₂ ² [°]			[kg]	[N]	[N]	
BEF 20		77	33	10,0	26	30	14,5	9,0			0,386	30805	82200	

PRODUCT FEATURES

Brand	DURBAL
N° Ean13	3663952508214
Inside diameter	20 mm
Outside diameter	50 mm
Thickness	25 mm
Type	SI
Weight	386 g
Thread	Left-hand thread
Lubrication	without
Packaging	1

contact@123bearing.com

(646) 712 9672

CRT4 de Lesquin 60 Rue Du Haut De Sainghin 59273 Fretin FRANCE