

SI Rod end

BEF16SO-21-502-DURBAL - BEF16SO-21-502-DURBAL

<https://www.123bearing.com/bearing-housing/rod-end/si/bef16so-21-502-durbal>

BEF16SO-21-502



rod end housing:
forged steel, tempered, surface galvanized, free of Cr-VI

joint ball:
ball bearing steel, hardened and ground, surface superfinished and chromium plated

race:
nylon / teflon / glass fibre compound

tolerances:
see page 10

DURBAL® heavy-duty rod ends with integral spherical plain bearing

female thread:
maintenance free, adapter sizes according to DIN ISO 12240-4, series K, thread according to ISO 8139

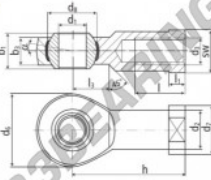

order number		measurements [mm]									
type	type	d1	d2	d3	d4	d5	d6	d7	d8	h1	h2
BEF 16 SO -21	-502	16	22,0	M 16 x 1,5	42	27	28,52	21	15,0		
measurements [mm]		weight									
type	h	l	l1	l2	SW	α1°	α2°	weight	basic load rating		
BEF 16 SO	64	28	8,0	22	22	15,5	8,5	0,233	dyn. C	stat. C0	stat. C1
									[N]	[N]	[N]
									22410	59600	

PRODUCT FEATURES

Brand	DURBAL
N° Ean13	3663952508177
Inside diameter	16 mm
Outside diameter	42 mm
Thickness	21 mm
Type	SI
Weight	233 g
Thread	Left-hand thread
Lubrication	without
Packaging	1

contact@123bearing.com

(646) 712 9672

CRT4 de Lesquin 60 Rue Du Haut De Sainghin 59273 Fretin FRANCE