

TPN Rod end GK45-DO-DURBAL - GK45-DO-DURBAL

<https://www.123bearing.com/bearing-housing/rod-end/tpn/gk45-do-durbal>

GK45-DO



Description: DIN ISO Hydraulic rod end with welding slope and dowel pin at the end of rod. Made of spherical plain bearing DGE... ES (ES-2RS) pressed into rod end housing. Sliding combination steel / steel.
Type DGK...DO-2RS with two additional seals available on request with grease nipple.

hydraulic rod ends, according to DIN ISO 12240-4, series E

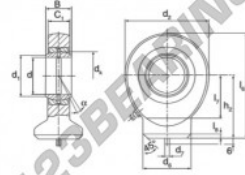

Sliding combination: steel / steel

Inner ring: bearing steel, hardened, ground and phosphated

Outer ring: bearing steel, hardened, ground and phosphated

Lubrication: lubrication required

* without grease nipple
** with grease nipple

order number	d	d ₁	d ₂	measurement [mm]			B	C ₁
GK 45 DO	45	50,7	102	6	58,0	32	27	

type	h ₁	h ₂	measurement [mm]		D	d ₁	α [°]	load rating C ₀ [kN]	weight [kg]
GK 45 DO	77	128,0	52,0	4,0	68	60,0	7	208,0	1,800

PRODUCT FEATURES

Brand	DURBAL
N° Ean13	3663952501451
Inside diameter	45 mm
Outside diameter	102 mm
Thickness	32 mm
Type	TPN
Weight	1800 g
Lubrication	with
Packaging	1

contact@123bearing.com

(646) 712 9672

CRT4 de Lesquin 60 Rue Du Haut De Sainghin 59273 Fretin FRANCE