

TAPR Rod end GIHN-KL-110LO-DURBAL - GIHN-KL-110LO-DURBAL

<https://www.123bearing.com/bearing-housing/rod-end/tapr/gihn-kl-110lo-durbal>

GIHN-KL-110LO



Description: Hydraulic rod end with slot and clamping arrangement. Made of spherical plain bearing DGE. LO pressed into rod end housing. Sliding combination steel / steel with grease nipple.

* without grease nipple

female thread;
hydraulic rod ends,
according to
DIN 24338

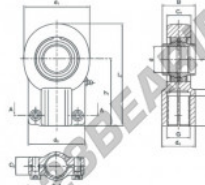

Sliding combination:

steel / steel

Inner ring:
bearing steel, hardened, ground and phosphated

Outer ring:
bearing steel, hardened, ground and phosphated

Lubrication:
lubrication required

order number	d	d ₂	measurement [mm]	G	d ₁	B	C ₁	C ₂
right hand thread								
left hand thread								
GIHN-KL 110 LO	110	235	M 90 x 3	125,0	190	110	88	62

type	l ₁ min	measurement [mm]	l ₂	l ₃	load rating	weight
		h ₁	l ₂	l ₃	C ₀ [kN]	[kg]
GIHN-K / GIHN-KL 110 LO	106	235	364,0	105	1200,0	32,00

PRODUCT FEATURES

Brand	DURBAL
N° Ean13	3663952500539
Inside diameter	110 mm
Outside diameter	235 mm
Thickness	88 mm
Type	TAPR
Weight	32000 g
Thread	Left-hand thread
Lubrication	with
Packaging	1

contact@123bearing.com

(646) 712 9672

CRT4 de Lesquin 60 Rue Du Haut De Sainghin 59273 Fretin FRANCE