

## TAPR Rod end GIHN-K-80LO-DURBAL - GIHN-K-80LO-DURBAL

<https://www.123bearing.com/bearing-housing/rod-end/tapr/gihn-k-80lo-durbal>

### GIHN-K-80LO



**Description:** Hydraulic rod end with slot and clamping arrangement. Made of spherical plain bearing DGE. LO pressed into rod end housing. Sliding combination steel / steel with grease nipple.

\* without grease nipple

female thread;  
hydraulic rod ends,  
according to  
DIN 24338

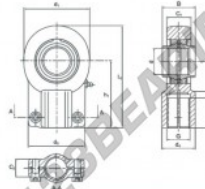

**Sliding combination:**

steel / steel

**Inner ring:**  
bearing steel, hardened, ground and phosphated

**Outer ring:**  
bearing steel, hardened, ground and phosphated

**Lubrication:**  
lubrication required

order number	d	d <sub>1</sub>	measurement [mm]	d <sub>2</sub>	B	C <sub>1</sub>	C <sub>2</sub>
right hand thread	80	168	M 64 x 3	90,0	148	80	66
left hand thread	80	168	M 64 x 3	90,0	148	80	66
GIHN-K 80 LO	80	168	M 64 x 3	90,0	148	80	66

type	l <sub>1</sub> min	measurement [mm]	l <sub>2</sub>	l <sub>1</sub>	load rating	weight
GIHN-K / GIHN-KL 80 LO	86	180	270,0	78	695,0 [kN]	14,50 [kg]

## PRODUCT FEATURES

Brand	DURBAL
N° Ean13	3663952500416
Inside diameter	80 mm
Outside diameter	168 mm
Thickness	66 mm
Type	TAPR
Weight	14500 g
Thread	Right-hand thread
Lubrication	with
Packaging	1
Standard	No standard

[contact@123bearing.com](mailto:contact@123bearing.com)

(646) 712 9672

CRT4 de Lesquin 60 Rue Du Haut De Sainghin 59273 Fretin FRANCE