

## SI Rod end

### SIL28-T-K-DURBAL - DSIL28-T-K-DURBAL

<https://www.123bearing.com/bearing-housing/rod-end/si/dsil28-t-k-durbal>

#### SIL28-T-K



female thread:  
maintenance free,  
according to  
DIN ISO 12240-4,  
series K



**Description:** DIN ISO rod end K series. Made of spherical plain bearing DG...PW pressed into rod end body. Sliding combination steel / bronze-PTFE composite.

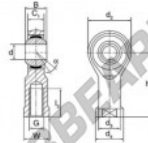

**Rod end body:**  
surface zinc plated

**Sliding combination:**  
steel / bronze-PTFE composite

**Inner ring:**  
bearing steel, hardened, ground and spherical surface chromium plated

**Outer ring:**  
brass body pressed around, outer race lined with bronze-PTFE composite

**Lubrication:**  
maintenance free

order number	right hand thread	left hand thread	d	G	B	C <sub>1</sub>	d <sub>2</sub>	d <sub>3</sub>	d <sub>4</sub>
SIL 28 T/K			28	M 27 x 2	35	24,00	66	37,0	46

type	measurement (mm)			d <sub>1</sub>	load rating C <sub>10</sub> (N)	weight (kg)
	l <sub>3</sub> min	W	h			
SI / SIL 28 T/K	51	41	103	15	107,0	0,820

## PRODUCT FEATURES

Brand	DURBAL
N° Ean13	3663952489650
Inside diameter	28 mm
Outside diameter	66 mm
Thickness	35 mm
Type	SI
Weight	820 g
Thread	Left-hand thread
Lubrication	without
Packaging	1

[contact@123bearing.com](mailto:contact@123bearing.com)

(646) 712 9672

CRT4 de Lesquin 60 Rue Du Haut De Sainghin 59273 Fretin FRANCE