

GE Rod end LHS10-IKO - LHS10-IKO

<https://www.123bearing.com/bearing-housing/rod-end/ge/lhs10-iko>

IKO

L-BALL

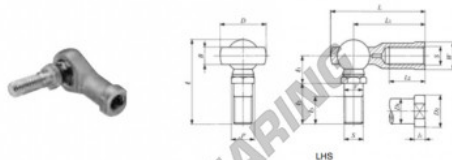

Identification number	Mess (Ref.) g	Boundary dimensions mm												
		Thread												
		S	F	D	B	L	L ₁	L ₂	l ₁	W	D ₁	D ₂	l	P
LHS 10	102	M10 x 1.5	10	28	10.5	57	43	23	6.5	17	15	19	52.5	13

				Static load capacity	
l ₁	l ₂	l ₃	Ball dia.	C _s	N
17	26	18	19.05	7 640	

PRODUCT FEATURES

Brand	IKO
N° Ean13	3616060465108
Inside diameter	10 mm
Type	GE
Weight	102 g
Thread	Right-hand thread
Lubrication	without
Packaging	1

contact@123bearing.com

(646) 712 9672

CRT4 de Lesquin 60 Rue Du Haut De Sainghin 59273 Fretin FRANCE